

## EYE TERMINALS

Polished Stainless Steel - **AISI 316**

ART. NO.	WIRE	A	B	D1	D2	L1	L2	B.L./KG	KG/100	PACK
190002	2 1/16"	3	12	5,50	5,5	41	24	1200	0,9	100
190025	2,5 3/32"	3	12	5,50	5,5	44	27	1000	0,8	100
190003	3 1/8"	4	14	6,35	6,5	60	38	1300	1,3	100
190332	1/8"	4	14	6,35	6,5	60	38	1300	1,4	100
190004	4 5/32"	5	17	7,50	8,5	67	45	1700	2,3	100
190005	5 3/16"	6	21	9,00	10,5	79	51	2400	3,9	25
190006	6 -	8	25	12,58	13,0	94	64	5500	8,7	10
190006X	6 -	10	28	12,58	13,2	105	64	5500	11,2	10
190007	7 9/32"	9	27	14,20	13,0	104	70	6800	11,5	10
190007X	7 9/32"	10	28	14,20	13,2	110	70	6800	13,5	10
190008	8 5/16"	10	30	16,00	14,5	124	83	8000	17,0	10
190008D	8 5/16"	10	30	13,00	14,5	123,5	83	4600	13,5	10
190008X	8 5/16"	12	36	16,00	16,5	141	83	8700	23,5	10
190010	10 -	11	35	17,80	16,3	137	89	9700	25,0	10
190010X	10 -	16	40	17,80	19,5	165	100	9700	38,0	10
190012	12 -	15	40	20,00	19,3	156	105	11400	41,5	5
190012X	12 -	15	42	21,40	19,3	178	120	14200	41,0	5
190014	14 -	18	47	25,00	23,0	206	140	15900	75,6	5
190016	16 -	20	53	28,00	26,0	232	160	19000	102,0	5
190019	19 -	25	65	34,50	28,5	302	200	31000	209,0	BULK
190020	20	25	65	34,50	28,5	302	200	31000	199,8	BULK
190022	22 -	30	70	40,40	33,0	348	230	42000	314,0	BULK
190026	26 -	30	77	46,00	36,0	400	280	53000	425,0	BULK
190028	28 -	38	84	50,00	40,5	445	300	64000	602,4	BULK



Blue Wave Eye terminals are engraved with the wire size and swage depth, making them easier to work with and to press or swage onto the wire. Eyes are mainly used as an attachment to rigging screws or forks.

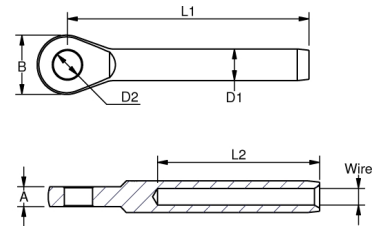

## RIGGING SCREWS EYE-EYE

Polished Stainless Steel - **AISI 316**

ART. NO.	G	A	D1	D2	L1	L2	B.L./KG	KG/100	PACK
191905	M5	3,0	5,5	12,0	190	131	800	4	10,0
191906	M6	4,0	6,5	14,0	204	136	1200	11	10,0
191908	M8	5,0	8,5	17,0	244	164	2200	14	5,0
191910	M10	6,0	10,5	22,0	270	187	3500	23	5,0
191912	M12	8,0	13,0	25,0	334	226	5100	38	5,0
191914	M14	9,0	13,0	28,0	376	257	6800	51	BULK
191916	M16	10,0	14,5	31,0	408	278	9400	73	BULK
191920	M20	15,0	19,5	40,0	488	334	14700	105	BULK
191922	M22	18,0	23,0	47,0	597	416	15200	354	BULK
191924	M24	20,0	26,0	53,0	713	480	17700	670	BULK
191927	M27	25,0	28,5	65,0	759	527	23000	710	BULK
191930	M30	30,0	33,0	70,0	861	581	28000	991	BULK
191936	M36	30,0	36,0	80,0	892	618	41000	1288	BULK

Note: All breakloads are determined by eye (D1) & thread  
M20 > M36 Available with threaded Bronze inserts in a S/S Body

